

easeArm

For snow 7^{HD} **plus**



User's Guide

V1.0

ZOOMAX Technology Co., Limited
9F, Building D, Paradise Software Park,
No.3 Xidoumen Road, Xihu District, Hangzhou, China
310012

Copyright© 2017 ZOOMAX Technology Co., Limited. All Rights Reserved.

ZOOMAX[®] is a trademark of ZOOMAX Technology Co., Limited in the United States and other countries. Information in this document is subject to change without notice. No part of this publication may be reproduced or transmitted in any forms or by any means electronic or mechanical, for any purpose, without the express written permission of ZOOMAX.

To contact by e-mail, send questions to sales@zoomax.co. To search the knowledge base, please visit www.zoomax.co and select the relevant links.

CONTENTS

1. INTRODUCTION	1
2. GET TO KNOW THE EASEARM	2
2.1 Accessories	2
2.2 Assembly step	3
3. OPERATION	6
3.1 For text-to-speech	6
3.2 For handwriting	7
3.3 For real-time viewing	9
4. SPECIFICATION	10

1. Introduction

➤ About your easeArm

Congratulations on purchasing your easeArm, an assistant arm designed for Snow 7 HD Plus. Please read this user's guide carefully before using. This guide will help you understand the easeArm's features better and allow you to get the full benefit of the easeArm and your Snow 7 HD Plus video magnifier.

➤ About this User's guide

We constantly seek to improve our products and their performance. Therefore, this guide may not be the latest version. You can still download the latest user's guide in the Support section at www.zoomax.co.

If you have any questions after reading this guide, please contact your supplier for further assistance.

2. Get to know the easeArm

2.1 Accessories

You would find the following accessories inside the easeArm package box:



(a) The main body



(b) M6 bolt



(c) Pedestal

If any items is missing from your package, please contact your distributor.

2.2 Assembly steps

➤ Step 1

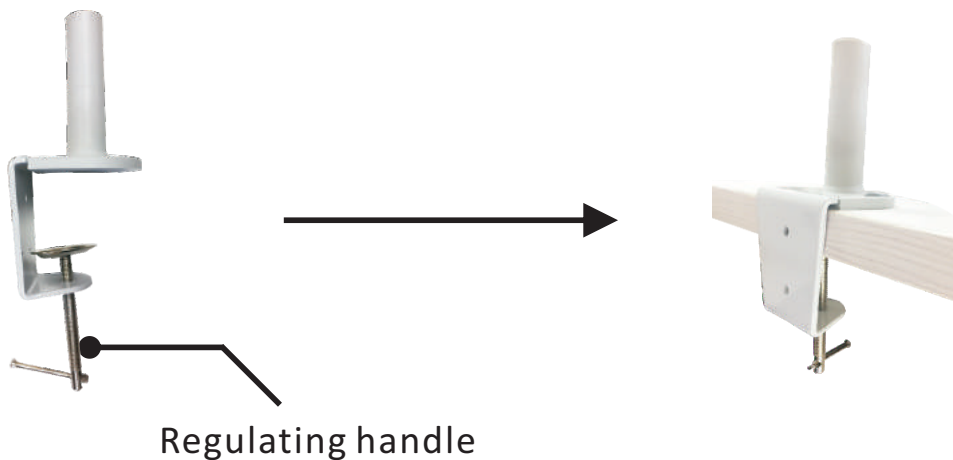

- Fix the pedestal to the desk by adjusting the regulating handle.

➤ Step 2

- Fasten the M6 bolt to the main body by hand.

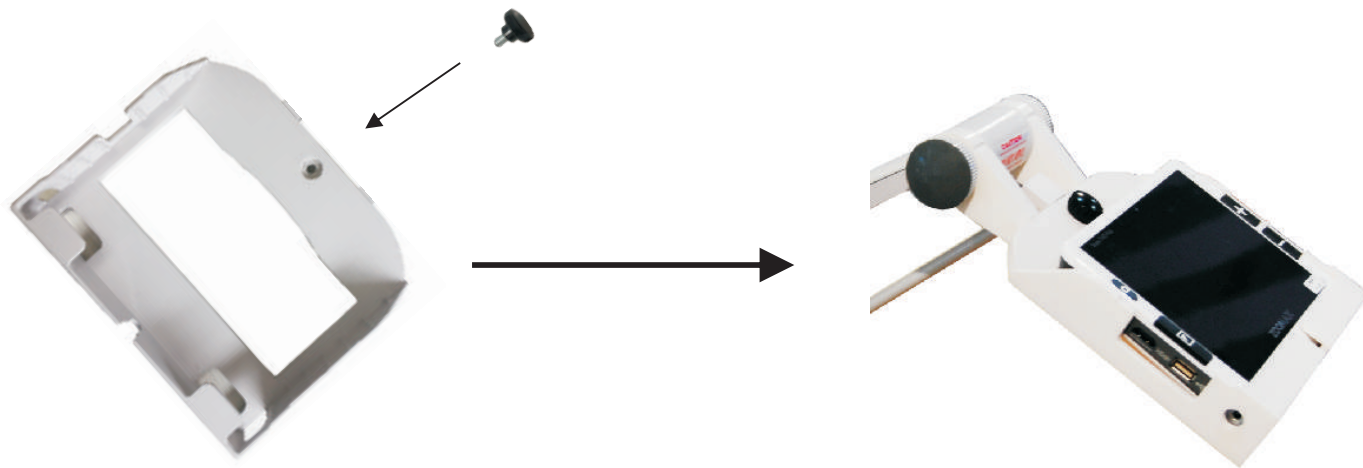

➤ Step 3

- Place the main body on the pedestal to finish the installation.



3. Operation

Put the Snow 7 HD Plus on the tray of the easeArm.

Adjust the height of the tray by raising or pulling down the tray.

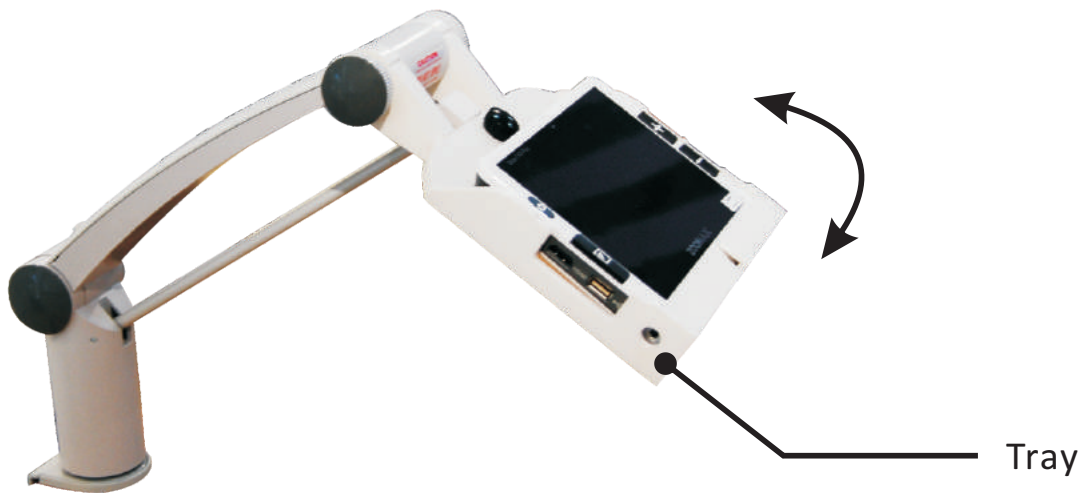

3.1 For the text-to-speech function

Lift the tray with Snow 7 HD Plus on it to capture more contents on the reading material. The recommended maximum height is the height that can be taken an entire A4 sheet. The distance between the device camera and reading material is 205mm. We recommend using double lights ON on matte paper and double lights OFF on glossy paper.

3.2 For handwriting

The easeArm can also be used for handwriting. For handwriting with the unit on easeArm, we recommend toggling the Near/Distance-view button to the Left direction  to use distance-viewing function. You can adjust the most suitable handwriting height according to your use habit.

We recommend turning the lights on or off according to the environment and your handwriting preferences.

NOTE:

Under the distance-view function, the double LED lights are OFF by default.



3.3 For real-time viewing

With the Snow 7 HD Plus on easeArm, the unit can also be used for real-time viewing. For real-time viewing, we recommend toggling the Near/Distance-view button to the Left direction  to use distance-viewing function.

To ensure the clearer picture quality, the maximum height from the camera of device to easeArm we recommend is 320mm for 15pt font size. If you read larger font, you can lift the easeArm a bit. If you read smaller font than 15pt, we recommend reducing the height of easeArm.

NOTE:

Please note that the picture quality may be not ideal if the easeArm has been adjusted too high.

NOTE:

Under the distance-view function, the double LED lights are OFF by default. To turn the LED lights on or off, please refer to the description in User's guide of Snow 7 HD Plus (chapter 5.1.1).

4. Specification

- Weight: 1310g (46.2 Oz)
- Packing size (W/H/D): 512 * 220 * 100 mm
- Recommend maximum height for text-to-speech: 205mm
- Recommend maximum height for real-time viewing: 320mm

ZOOMAX TECHNOLOGY CO., LIMITED

Add.: 9F, Building D, Paradise Software Park,
No.3 Xidoumen Road, Xihu District, Hangzhou,
Zhejiang Province, 310012, China.

Tel: +86-571-87006308

Fax: +86-571-87397220

Email: sales@zoomax.co

Visit us at: www.zoomax.co



Zoom Your Vision, Max Your Life